

# TECU® Patina

Pre-patinated copper  
for Roofing and  
Façade Cladding



KM Europa Metal AG  
TECU® Patina  
[GB]



|                             |   |
|-----------------------------|---|
| Quality                     | 2 |
| The Surface                 | 4 |
| Processing and Installation | 6 |
| Copper and Sustainability   | 8 |

|                              |    |
|------------------------------|----|
| TECU® System Products        | 10 |
| TECU® Sizes and Availability | 14 |
| TECU® Project Consulting     | 16 |
| TECU® References             | 18 |





*Green copper for immediate creative application – all natural, no limits.*



*Often the shortest path takes you directly to your goal. When the design demands the power and expressiveness of the patina green typical for copper, then it should be implemented just as required – without waiting for the gradual changes caused by natural weathering. The solution is TECU® Patina – patinated copper for immediate use to satisfy the highest aesthetic demands in building design.*

*Using a specially developed industrial process, TECU® copper sheets are patinated green on one side. This process causes an oxidised layer to form on the surface of the copper – a process similar to the natural patination that occurs over a long period of time when copper is exposed to atmospheric conditions. TECU® Patina is always extremely varied, just as you would expect from a natural surface. The many different colour tones and shades eventually blend together, but only gradually. The unique developments occurring in TECU® Patina are exciting – just as modern architecture should be.*





TECU® Patina sheets are manufactured in state-of-the-art production facilities according to DIN EN 1172 and KME's own strict guidelines. They are made of Cu-DHP – oxygen-free, phosphorus-deoxidised copper with limited residual phosphorus. Cu-DHP is well suited for welding and soldering; its degree of purity is at least 99.9%, in accordance with DIN 1787 "Copper, Wrought Products". Cu-DHP is outstandingly malleable, regardless of temperature and the direction of rolling.

TECU® Patina surpasses the requirements of DIN EN 1172 with regard to tolerances and the most important technological values. This gives the processed surfaces their excellent visual appearance.

#### ***New: TECU® Patina now with TSP surface protection***

The temporary yet robust transparent layer ensures long-lasting protection. Processing is virtually dust-free. Traces of processing remain practically invisible on the material surface, and even after folding and bending, the patina layer remains in good condition. After installation, the surface develops in the completely natural manner characteristic of copper.

TECU® Patina  
Quality



*“Beautiful? Absolutely stunning!  
For how long? Forever!”*







# TECU® Patina

## The surface



*“The most massive structure  
comes across as  
virtually weightless.”*

TECU® Patina has similar properties to those of natural patina right from the start. Its colouring continually changes on exposure to the elements. The lively colour spectrum so typical of copper develops over time. As a result of the manufacturing technology used, individual sheets can vary in colour from yellow green to blue green. Although these differences can be seen right after installation, they soon become less noticeable on exposure to the elements. Differences in the colour of natural surfaces like TECU® Patina are not a shortcoming, but rather a sign of quality. If TECU® Patina sheets are installed in interior areas, the colour assimilation requires a longer period, as the development of the patina is mainly influenced by humidity in the air. When installed in public buildings, TECU® Patina surfaces are better placed out of reach, or in constructional areas that are screened off from touch.\*

\* TECU® Project Consulting stands by ready to help.









# TECU® Patina

## Processing and Installation



The physical appearance of TECU® Patina is influenced by the installation and the system applied. A combination of copper's typical properties, such as malleability, high ultimate elongation, high melting point etc. lend TECU® Patina its special suitability for all metal-specific processing techniques from traditional seaming to modern cladding. TECU® Patina can be processed like bright rolled copper using standard techniques and machines. However, due to the special features of the Patina surface, a few important guidelines as to processing, material properties, transportation and storage should be kept in mind.

*“Wind and weather create their own kind of beauty.”*

# Copper and sustainability

Copper is the building material for aesthetic, ambitious and long-term cost-effective building solutions. The advantages of copper in the installation process and the fact that it can be completely recycled make it an outstanding choice of material for roofing and façade cladding.

Recycling comprises the entire process of preparing old material and scraps for reuse in subsequent production processes. The recycling of copper is as old as the use of copper itself. Copper is primarily used for projects requiring a long lifespan. Taking average use and return times, copper achieves a recycling rate of around 80 % over all of its various areas of application. Energy savings gained from the use of recycled copper material – sometimes known as secondary metal production – amount to as much as 92 % (depending on the type of scrap being processed) of the energy input required for the ore extraction and subsequent production processes.

Today, ecological considerations in relation to the choice of construction materials have joined aesthetic and economic aspects, and are the subject of intense public interest. Recycling copper helps the environment both directly and indirectly. Use of reused materials prevents waste and protects natural resources.

Sustainable construction is aimed at minimising the consumption of energy and resources and contaminating the economy of nature as little as possible in every phase of a building's lifecycle. The model of sustainable development aims at linking ecological, economic and social goals with one another.

## *Taking copper as an example*

**Ecological** means handling energy and resources sparingly and affecting the eco system as little as possible.

**Economic** means that it provides cost-effective solutions. In view of its exceptional durability and the fact that it is virtually maintenance free, copper is the right choice for the entire lifecycle of the product.

**Social** means that the copper industry is a key economic industry that works together with other industries to lay the foundation for technological progress and contribute towards improving our standard of living.







# TECU® System Products

## TECU® for Seamed and Batten Cap Cladding

Ideal for custom designed free forms as well as the traditional roof and façade construction design: using angle standing seams and batten cap cladding. TECU® Patina for these types of cladding is available in sheets.

The modern use of rolled copper in plumbing and roofing, the higher product quality requirements and the development of new, more demanding techniques for metalworking mean that copper has to meet much higher expectations today than ever before. TECU® sheets and strips for plumbing and roofing are manufactured in accordance with EN 1172 and KME's own strict quality control guidelines. Material tolerances for dimensions and properties are well within or even tighter than standard limits, and further processing by machine or hand is considerably easier.

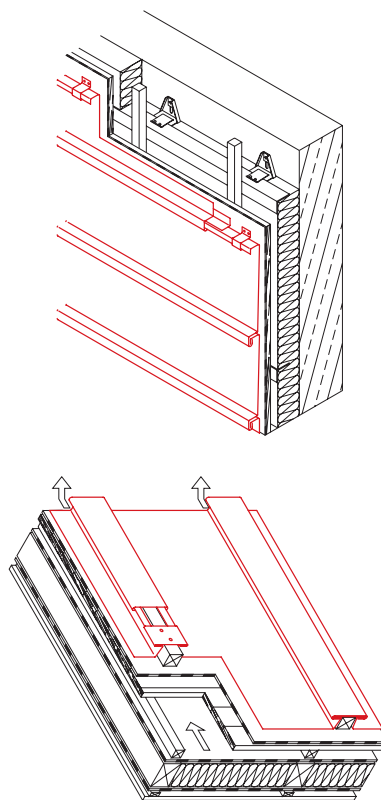



**TECU® System Shingles**  
**TECU® System Rhomboids**



Besides their special aesthetic qualities, TECU® System Shingles and TECU® System Rhomboids offer decisive economic advantages in façade design: cladding elements are laid simply by hanging them and interlocking them with each other.

The shingles and diamond system shingles have a 180° border on all sides. Two sides are provided with a fold coming forward or with a downstand. The individual elements are available as left or right tiling. All folds and notches are automatically pre-processed in the factory. At the edges, all the usual processing techniques such as bevelling, folding and bending can be used. This ensures that the corners of buildings and connections to other constructional elements such as windows and doors are completely weatherproof.

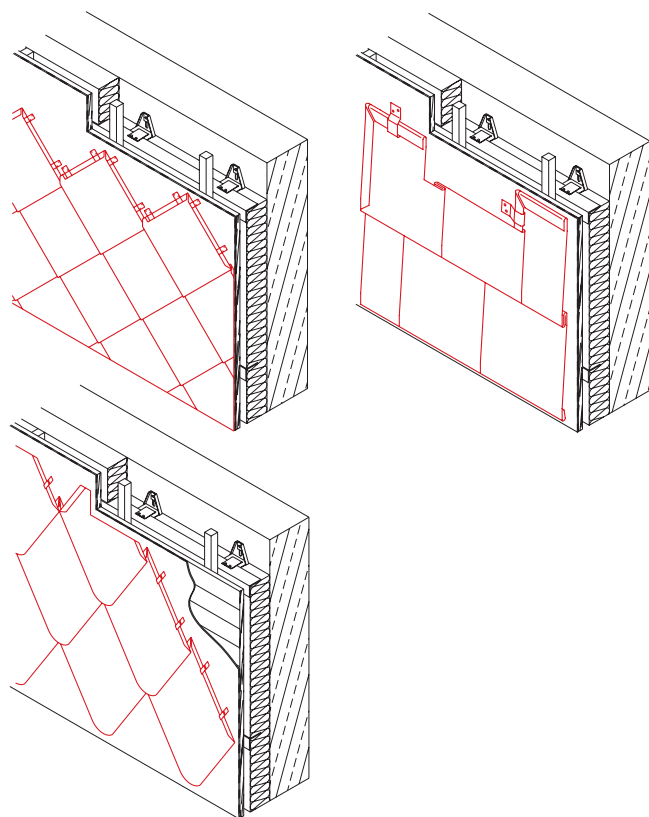

## TECU® Panels

TECU® Panels are two-sided cladding elements, with or without an end base, depending on the construction. Individual lengths are as long as 4,000 mm with a standard width of up to approx. 500 mm. Assembly at the building site is performed according to the tongue and groove principle or by overlapping.

The panels can be assembled in various directions – vertically, horizontally or diagonally. There are three basic forms, depending on the design:

- Slot-in panels laid vertically as a level surface facade cladding
- Slot-in panels laid horizontally as a level surface facade cladding
- Special panels with visible or concealed fixings, laid in various ways, with a level surface or overlapped

## TECU® Cassettes

TECU® Cassettes are cladding elements with folded edges on all sides available in a range of geometrical proportions from 1:1 to 1:4. They are exclusively pre-profiled to the customer's specifications and/or according to suggestions made by the architect.

Cassette cladding allows a great deal of flexibility concerning formats, the layout of joints and fixing principles. Folded edges on every side allow even larger sheet metal parts to lie even with the cladding surface.

Fixing is usually achieved by riveting, screwing, hidden/subsurface fittings or by means of bolt hooks to fix the cassettes directly to the substrate.

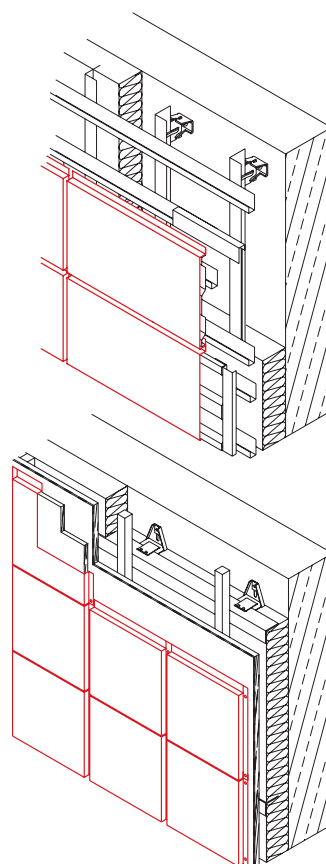
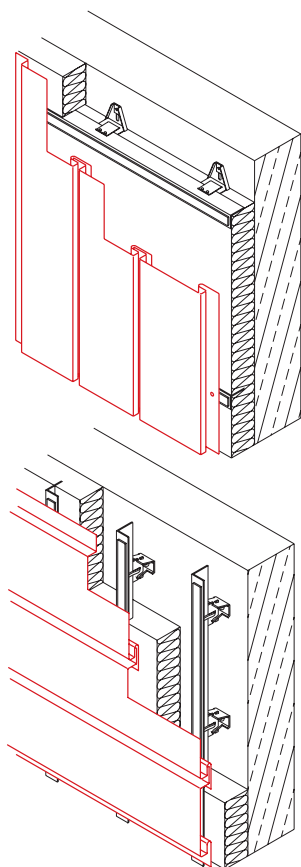



# TECU® Rainwater Systems

TECU® roofing and cladding systems can be supplemented by rainwater system components from Fricke GmbH & Co. of Greven, Germany.





Their product range includes

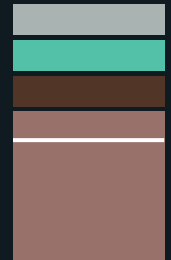





- eaves gutters, half-round (lengths of 3 – 6 m) or
- eaves gutters, box section (lengths of 2 or 3 m)
- gutter brackets
- downpipes
- rainwater pipe brackets
- standpipe
- accessories







# TECU® Sizes and Availability

## TECU® Sheets



| TECU® Classic   |  | 0.5 | 0.6 | 0.7 | 1.0 | 1.2 | 1.5 | 2.0 |
|---|--|-----|-----|-----|-----|-----|-----|-----|
| Format/Thickness  |  |     |     |     |     |     |     |     |
|  1000 x 2000 |  |     | •   | •   | •   |     | •   | •   |
|  1000 x 3000 |  |     | •   | •   | •   |     | •   | •   |
|  1250 x 2500 |  |     | •   | •   | •   |     | •   | •   |

| TECU® Patina   |  | 0.5 | 0.6 | 0.7 | 1.0 | 1.2 | 1.5 | 2.0 |
|--|--|-----|-----|-----|-----|-----|-----|-----|
| Format/Thickness   |  |     |     |     |     |     |     |     |
|  600 x 2000   |  |     |     | •   |     |     |     |     |
|  600 x 3000   |  |     |     | •   |     |     |     |     |
|  670 x 2000   |  |     | •   | •   |     |     |     |     |
|  670 x 3000   |  |     | •   | •   |     |     |     |     |
|  800 x 3000   |  |     |     | +   | +   |     |     |     |
|  1000 x 2000  |  |     | •   | •   | +   | +   |     |     |
|  1000 x 3000 |  |     | •   | •   | •   | +   | +   |     |





Manually patinated longer sheets available on request

| TECU® Brass   |  | 0.5 | 0.6 | 0.7 | 1.0 | 1.2 | 1.5 | 2.0 |
|---|--|-----|-----|-----|-----|-----|-----|-----|
| Format/Thickness  |  |     |     |     |     |     |     |     |
|  670 x 2000  |  |     |     | •   |     |     |     |     |
|  670 x 3000  |  |     |     | •   |     |     |     |     |
|  1000 x 2000 |  |     |     | •   | •   |     |     |     |
|  1000 x 3000 |  |     |     | •   | •   |     |     | +   |

Burnishing by FRICKE GmbH & Co. KG available on request

| TECU® Bronze   |  | 0.5 | 0.6 | 0.7 | 1.0 | 1.2 | 1.5 | 2.0 |
|--|--|-----|-----|-----|-----|-----|-----|-----|
| Format/Thickness   |  |     |     |     |     |     |     |     |
|  670 x 2000 |  |     |     | •   | •   |     |     |     |
|  670 x 3000 |  |     |     | •   | •   |     |     |     |











Burnishing by FRICKE GmbH & Co. KG available on request



| TECU® Gold  |  | 0.5 | 0.6 | 0.7 | 1.0 | 1.2 | 1.5 | 2.0 |
|---|--|-----|-----|-----|-----|-----|-----|-----|
| Format/Thickness  |  |     |     |     |     |     |     |     |
|  670 x 2000  |  | +   |     | •   | •   |     |     |     |
|  670 x 3000  |  | +   |     | •   | •   |     |     |     |
|  1000 x 2000 |  |     |     | +   | +   |     |     |     |
|  1000 x 3000 |  |     |     | +   | +   |     |     |     |



- available
- + on request



Other dimensions and availability available on request.  
Further information: Project Consulting, Tel. +49 541 321-2000  
All measurements in mm.

## TECU® Strips

| TECU® Classic  |  | 0.5 | 0.6 | 0.7 | 1.0 |
|--|--|-----|-----|-----|-----|
| Width/Thickness  |  |     |     |     |     |
|  200  |  |     | •   | •   |     |
|  250  |  |     | •   | •   |     |
|  333  |  |     | •   | •   |     |
|  400  |  |     | •   | •   |     |
|  500  |  |     | •   | •   |     |
|  600  |  |     | •   | •   |     |
|  670  |  |     | •   | •   |     |
|  800  |  |     | •   | •   |     |
|  1000 |  |     | •   | •   |     |
|  1220 |  |     | •   | •   |     |
|  1250 |  |     | •   | •   |     |

| TECU® Oxid  |  | 0.5 | 0.6 | 0.7 | 1.0 |
|---|--|-----|-----|-----|-----|
| Width/Thickness   |  |     |     |     |     |
|  500 |  |     | •   | •   |     |
|  600 |  |     | •   | •   |     |
|  670 |  |     | •   | •   |     |

| TECU® Zinn  |  | 0.5 | 0.6 | 0.7 | 1.0 |
|---|--|-----|-----|-----|-----|
| Width/Thickness   |  |     |     |     |     |
|  500 |  |     | +   | +   |     |
|  600 |  |     | •   | •   |     |
|  670 |  |     | •   | •   |     |

| TECU® Brass  |  | 0.5 | 0.6 | 0.7 | 1.0 |
|--|--|-----|-----|-----|-----|
| Width/Thickness  |  |     |     |     |     |
|  670  |  |     |     | +   | +   |
|  1000 |  |     |     | +   | +   |

| TECU® Bronze  |  | 0.5 | 0.6 | 0.7 | 1.0 |
|---|--|-----|-----|-----|-----|
| Width/Thickness   |  |     |     |     |     |
|  670 |  |     |     | +   | +   |

| TECU® Gold   |  | 0.5 | 0.6 | 0.7 | 1.0 |
|--|--|-----|-----|-----|-----|
| Width/Thickness  |  |     |     |     |     |
|  1000 |  | +   |     | +   | +   |

## TECU® Net TECU® Bond

## TECU® System Products

### TECU® Net (stretch levelled)

| Thickness                          | 0.7 | 1.0 |
|------------------------------------|-----|-----|
| Format 1000 x 2000                 | •   | •   |
| Format 1000 x 3000                 | •   | •   |
| TECU® Net Classic                  | •   | •   |
| Other formats available on request |     |     |

### TECU® Net (stretched)

| Thickness         | 1.2        |
|-------------------|------------|
| Format            | on request |
| TECU® Net Classic | +          |
| TECU® Net Patina  | +          |

### TECU® Net (perforated)

| Thickness                          | 1.0 |
|------------------------------------|-----|
| Format 1000 x 2000                 |     |
| TECU® Net Classic                  | +   |
| TECU® Net Patina                   | •   |
| TECU® Net Brass                    | +   |
| Thickness                          | 1.0 |
| Format max. 670 x 2000             |     |
| TECU® Net Bronze                   | +   |
| TECU® Net Gold                     | +   |
| Other formats available on request |     |

### TECU® Bond

|  |     |
|--|-----|
| Nominal thickness  | 4.0 |
| Thickness of copper 0.3 on both surfaces (alternatively 0.5) |     |
| Format 1000 x 3000   |     |
| TECU® Bond Classic   | •   |
| TECU® Bond Patina  | +   |
| TECU® Bond Brass   | +   |
| TECU® Bond Gold  | +   |

### TECU® System Shingles

| Format                                     | 600 x 600   | 600 x 600 |
|--|-------------|-----------|
|  | Rectangular | square    |
| TECU® Classic                              | •           | •         |
| TECU® Oxid                                 | •           | •         |
| TECU® Patina                               | •           | •         |
| TECU® Zinn                                 | •           | •         |
| TECU® Brass                                | +           | +         |
| TECU® Bronze                               | +           | +         |
| TECU® Gold                                 | +           | +         |
| Manufacture and sale: FRICKE GmbH & Co. KG |             |           |

### TECU® System Rhomboids

| Format                                     | 518 x 830 | 518 x 758 |
|--|-----------|-----------|
|  | Sharp     | Round     |
| TECU® Classic                              | •         | •         |
| TECU® Oxid                                 | •         | •         |
| TECU® Patina                               | •         | •         |
| TECU® Zinn                                 | •         | •         |
| TECU® Brass                                | +         |           |
| TECU® Bronze                               | +         | +         |
| TECU® Gold                                 | +         | +         |
| Manufacture and sale: FRICKE GmbH & Co. KG |           |           |

### TECU® Façade Tiles

| Format                                     | 200 x 200 |
|--|-----------|
| TECU® Classic                              | •         |
| TECU® Gold                                 | +         |
| Manufacture and sale: FRICKE GmbH & Co. KG |           |

### TECU® Panels

| Lengths up to 4000, Widths up to 400       |   |
|--|---|
| TECU® Classic                              | • |
| TECU® Oxid                                 | • |
| TECU® Patina <sup>1</sup>                  | • |
| TECU® Zinn                                 | • |
| TECU® Brass                                | • |
| TECU® Bronze                               | • |
| TECU® Gold                                 | • |
| <sup>1</sup> Lengths up to 3000            |   |
| Manufacture and sale: FRICKE GmbH & Co. KG |   |

### TECU® Cassettes

| Custom manufacturing                       |   |
|--|---|
| TECU® Classic                              | • |
| TECU® Oxid                                 | • |
| TECU® Patina                               | • |
| TECU® Zinn                                 | • |
| TECU® Brass                                | • |
| TECU® Bronze                               | • |
| TECU® Gold                                 | • |
| Manufacture and sale: FRICKE GmbH & Co. KG |   |

### TECU® Profiled sheets

| Corrugated and trapezoidal profiles        |   |
|--|---|
| Formats available on request               |   |
| TECU® Classic                              | + |
| TECU® Oxid                                 | + |
| TECU® Patina                               | + |
| TECU® Zinn                                 | + |
| TECU® Brass                                | + |
| TECU® Bronze                               | + |
| TECU® Gold                                 | + |
| Manufacture and sale: FRICKE GmbH & Co. KG |   |



# TECU® Project Consulting

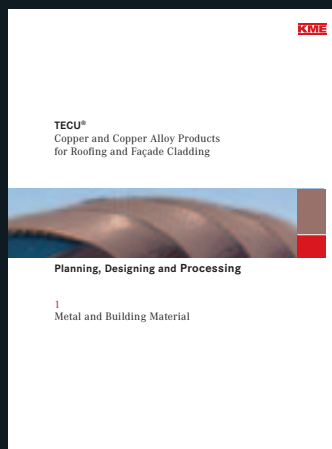

## Service

TECU® products from KME are made to meet the demands placed on them by all kinds of different constructions. Many of their recognized, quality features are a result of close communication with expert customers in the building industry.

TECU® stands for a combination of high quality and complete service. As the world's leading processor and refiner of copper and copper alloy products, KME provides its technical advisory service to developers, architects, clients and roofers throughout Europe and beyond.

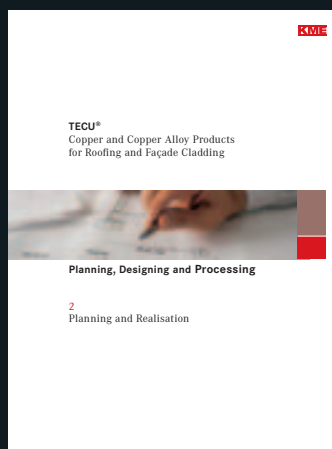

Information and consultation provided by TECU® Project Consulting ensure skilful use of materials, and make possible the realisation of perfect and aesthetically demanding solutions with TECU® products. The reference publication *TECU® - Planning, Designing and Processing*, is a rich source of detailed information – now available in five languages.



### Seminars and training courses

For everyday work in an architect's office, practical knowledge about the professional use of high-quality TECU® products is just as valuable as having reliable information about legal and organisational issues or new technologies. KME invites anyone with an interest in these issues to take part in special seminars for architects, which are held regularly in the **KMEForum** in Osnabrück.

The aesthetic and economic superiority of TECU® products is fully exploited when the material is used in a qualified manner in accordance with technical requirements. KME's TECU® Training Centre in Osnabrück offers multi-level professional seminars in which theoretical and practical processing techniques are taught at various levels of difficulty. Students apply their skills in practical work on models. The training events take place in the new **KMEForum** in Osnabrück, which is fully equipped with all modern training facilities, and offers a practice-oriented setting.

Courses are offered throughout Europe in collaboration with trade organisations and associations. This service is part of TECU® quality offered by KME.

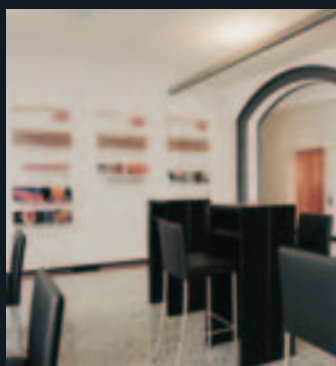

# TECU®

## Copper designs.

### Reference

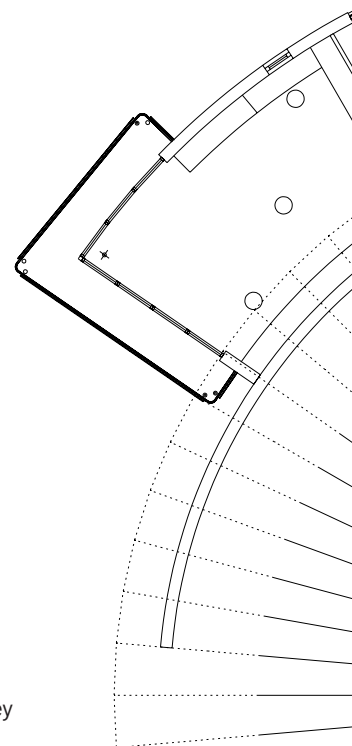

#### **“Thunderbird” House, Poole, GB**

Architects: Seven Developments Ltd., Poole

Copper Contractor: Pace Roofing Ltd., Romsey

Cladding: TECU® Patina

**In an attractive residential area with the most expensive real estate in Europe, a project was completed that more than lives up to its reputation in terms of its structural aesthetics and use of materials. The characteristic “wings” of the Thunderbird house in Poole, England were achieved by virtue of a stunning roof design using TECU® Patina panels.**

Eddie Mitchell, Managing Director of Seven Developments, is credited with wanting to turn sleepy Poole into Britain’s version of St. Tropez with his outrageous and unique homes. The key architectural features employed are white walls and facades, sinuous vertical surfaces, floor-to-ceiling coloured glass panels and highly sloping and curved roofs – made of copper, because there is scarcely any other material that allows so much creative scope and meets such exacting quality requirements. Many of the company’s properties have already won prestigious awards and prizes; including first prize for best private home for Thunderbird in the 2006 National Home Builder Design Award.

On the Sandbanks of Poole, a small spit of land opposite the harbour entrance and adjacent to Branksome Park on the east side, land prices are among the most expensive in the world. These high prices can be explained by the uninterrupted, breathtaking vistas over the largest natural harbour in the world and the great appeal of the coastline around Poole, including the Jurassic Coast World Heritage Site. Wealthy buyers pay top prices to move into Seven Developments’ fully fitted and furnished properties, which feature excellent quality materials and exquisite finishes.

The stunning, luminous green copper roof of the Thunderbird and the choice of TECU® Patina are, so to speak, representative of the high quality standard of the house. Aesthetic appeal, natural qualities and high efficiency due to the excellent protection from the elements and long-lasting roof cladding are perfectly complemented by other environmentally sound “green” components such as thermal glazing, energy-saving lighting and Thermolite interior walls. The quality materials used are also in tune with the uncompromising high-tech gadgetry of the building, including the latest in entertainment systems, complete furnishings and fitted kitchen.





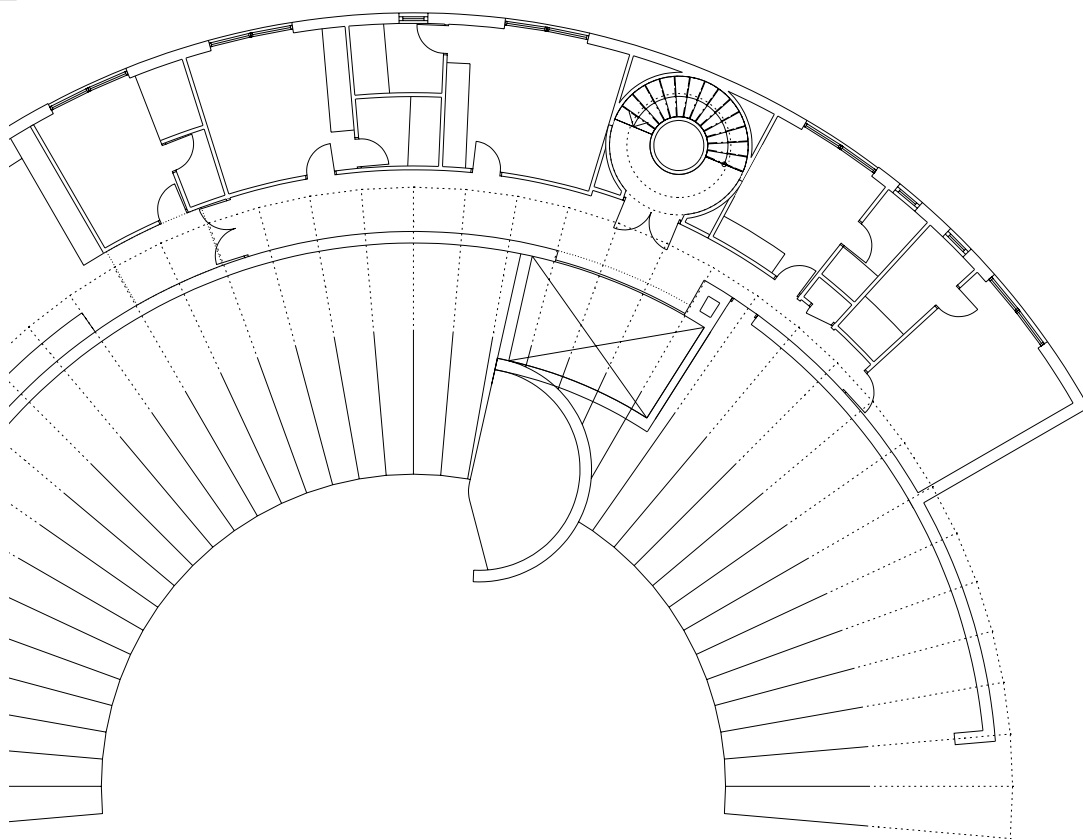

# TECU®

## Copper designs.

### Reference

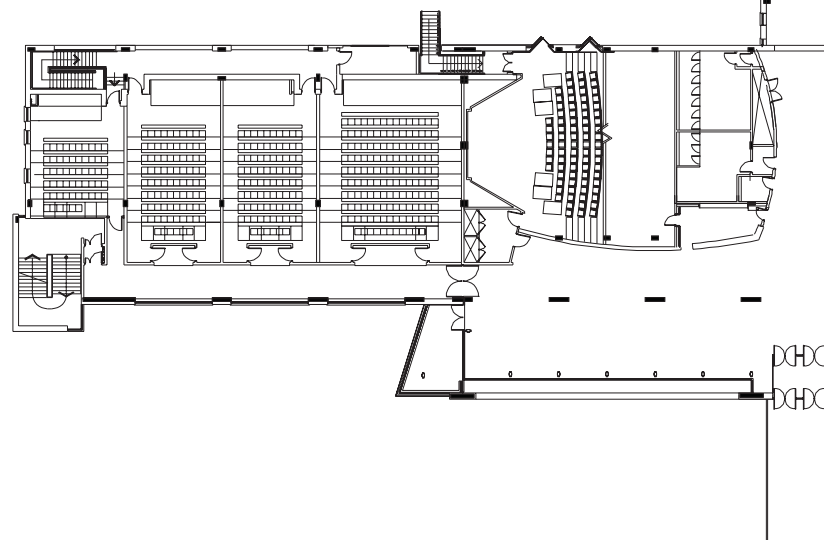

#### Galway-Mayo Institute of Technology, Galway, IRL

Architects: Murray O'Laoire Architects, Cork

Copper Contractor: Let it Rain Roofing Ltd., Galway

Cladding: TECU® Patina

**An extension to a technology institute in the county of Galway in Ireland has created a very spectacular landmark. Sail-like façade elements constructed from green pre-patinated copper symbolically point towards the ocean.**

The building complex of the Galway/Mayo Institute of Technology was extended by a modern Learning Resource Centre which includes a library and IT media section. Taking full account of local conditions and utilising mainly local building materials, the new building now essentially presents itself in native limestone and patinated copper. The architects decided to use TECU® Patina – on the one hand, because of its powerful, vibrant patina green colour and on the other, because of its malleable qualities which were ideally suited to the planned organic shapes of the building's design features.

The new building was structured in two cuboid units, one of which is home to the lecture block, while the other contains the library and IT media centre. The main entrance is located at the interface between the two building units, demarcating the new axial route through the existing college complex. To balance out the different land levels between the old and new buildings, a cantilever bridge joins the entrance with a triangular wedge of land which rises towards the Learning Resource Centre. A free-form fabric canopy projecting from the façade and covering the entire bridge offers pedestrians protection from the elements. The organic form language sets a counterpoint to the otherwise straight lines of the façade. This is very impressively continued on the façade of the library, where three copper-clad segments reach out to the landscape with the help of a steel-framed construction. The free form compositions reflect the shape of trapezoidal sails and take cognisance of Galway's location on the Atlantic coast and the city's maritime history. But besides their design aspect, the three copper sails also have another dimension. They protect against the sun as well as acting as acoustic baffles and light reflectors. They also function as large air dispensers, and form part of the library's natural ventilation strategy.

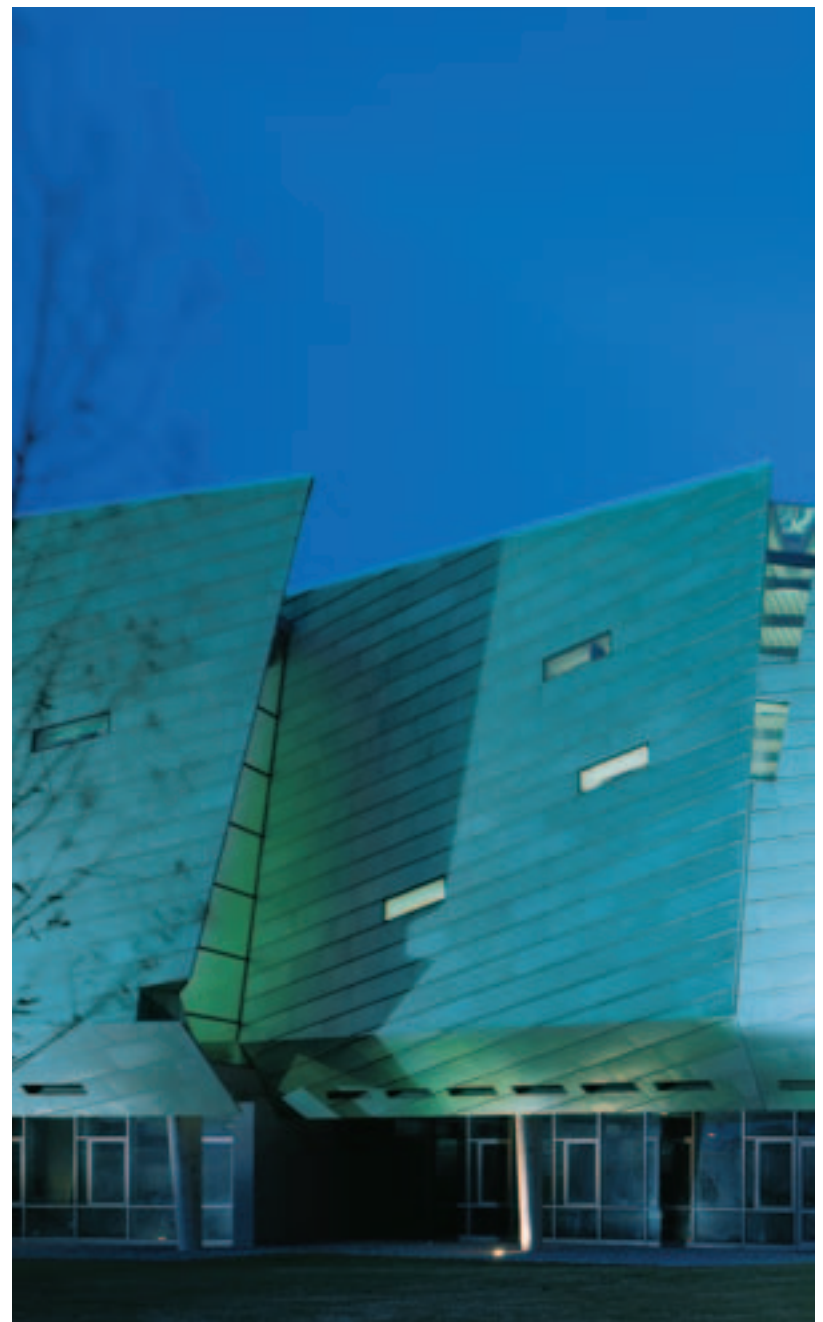



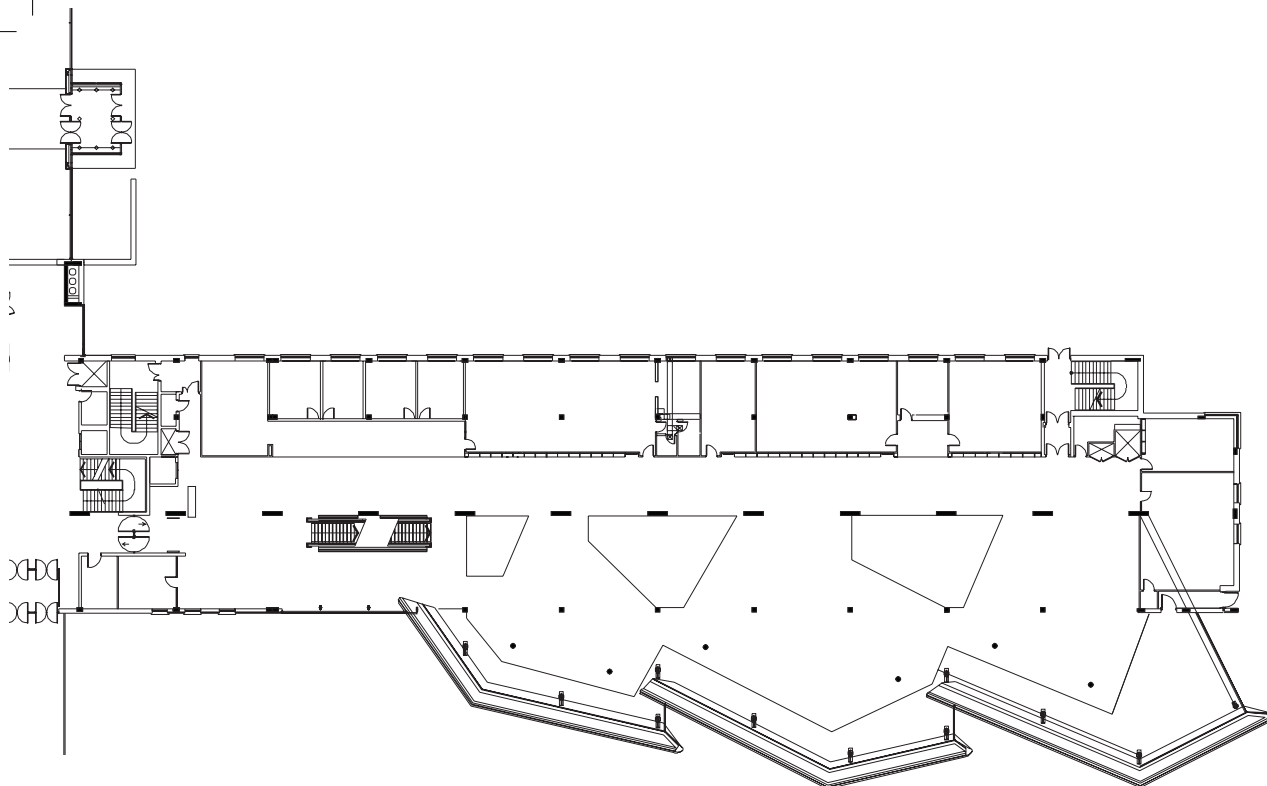



# TECU® References

TECU® Classic

TECU® Classic

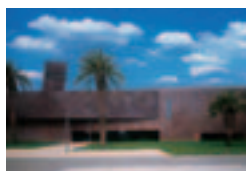

**De Young Memorial Museum, San Francisco, USA**  
Herzog & de Meuron Architekten, Basel, CH  
*A. Zahner Co. Architectural Metals, Kansas City*  
TECU® Classic



**Service Centre Theresienwiese, Munich, D**  
Volker Staab Architekten, Berlin  
*Regensburger Metallbau, Regensburg*  
TECU® Classic



**Poppodium Mezz, Breda, NL**  
(EEA) Erick van Egeraat associated architects, Rotterdam  
*SV Metaaldak Specialist BV, Beek en Donk / Brouwers Zink BV, Maasmechelen*  
TECU® Classic



**Offices and industrial building, Koblach, A**  
AIX Architects, Feldkirch  
*Peter GesMBH + CoKG, Koblach*  
TECU® Classic

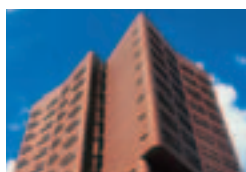

**Officer's quarters of the Royal Marines of the Netherlands, Den Helder**  
Van Herk & de Kleijn Architekten BV, Amsterdam  
*Ridder BV, Hoorn*  
TECU® Classic



**Casa Travella, Castel San Pietro, CH**  
Aldo Celoria, Balerna  
*Antonio Corti SA, Caslano*  
TECU® Classic



**Harbour Control Tower, Lisbon, P**  
Gonçalo Byrne, G.B. Arquitectos, Lisbon  
*Zn-Revestimentos de Zinco Lda., Maia*  
TECU® Classic



**THE CORE, Information Centre for the Eden Project, Cornwall, GB**  
Nicholas Grimshaw & Partners, London  
*Richardson Roofing Co. Ltd., Staines*  
TECU® Classic



**ESA - École Supérieure d'Art, Clermont-Ferrand, F**  
Architecture Studio, Paris  
*Raimond SA, Saint-Julien de Condelles*  
TECU® Classic



**Private Residence, Madrid, E**  
Bernalte y León Asociados, Ciudad Real  
*METAZINCO®, Madrid/Olloniego (Asturias)*  
TECU® Classic



**Kulturhus De Bijenkorf, Borneo, NL**  
MAS architectuur BV, Hengelo  
*Dakcentrum+, Beilen*  
TECU® Classic

**Object**  
Architects  
Copper Contractor  
Cladding

TECU® Patina

TECU® Patina



**Galway-Mayo Institute of Technology, Galway, IRL**  
Murray O'Laoire Architects, Cork  
*Let it Rain Roofing Ltd., Galway*  
TECU® Patina



**Villa ArenA (Restaurant), Amsterdam, NL**  
Virgile & Stone Associates Ltd., London  
in cooperation with Benthem Crouwel Architecten  
*Leebo bouwsystemen BV, Drunen*  
TECU® Patina



**Maggie's Highlands Cancer Caring Centre at Raigmore Hospital, Inverness, GB**  
Page & Park Architects, Glasgow  
*W B Watson Ltd., Stewarton*  
TECU® Patina, TECU® Oxid



**Peckham Library, London, GB**  
Alsop & Störmer, London  
*Clevecio, Enfield*  
TECU® Patina



**Pilgrimage Church Padre Pio, San Giovanni Rotondo, I**  
Renzo Piano Building Workshop, Genoa  
*WAL S.R.L., Bregnano*  
TECU® Patina



**Centro Stampa Quotidiani, Brescia, I**  
TECNE s.r.l., Brescia  
*Santinato, Erbusco*  
TECU® Patina



**Entrance to University Library, Debrecen, H**  
János Golda, János Megyik, Gábor Szenderffy, Budapest  
*Szolnok KAS Kft, Szolnok*  
TECU® Patina



**Office and shop building "KAI 13", Düsseldorf, D**  
Döring Dahmen Joeressen Architekten, Düsseldorf  
*Zitzen GmbH, Mönchengladbach*  
TECU® Patina



**"Thunderbird" House, Poole, GB**  
Seven Developments Ltd., Poole  
*Pace Roofing Ltd., Romsey*  
TECU® Patina

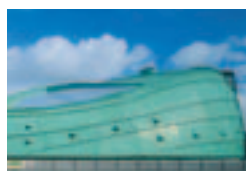

**ICL - International Centre for Life, Newcastle, GB**  
Terry Farell & Partners, London  
*Varla UK Ltd., Chester*  
TECU® Patina



**Underground station Hounslow West, London, GB**  
Michael Watkins (Partner), London, (Acanthus, Lawrence and Wrightson Architects)  
*Broderick Structures Ltd., Woking*  
TECU® Patina



**Urbis, Manchester, GB**  
Ian Simpson Architects, Manchester  
*Varla UK Ltd., Chester*  
TECU® Patina



**Private Residence, NL**  
Charles Slot Bureau Ruimtelijke Vormgeving, Bergen  
*PBK Technische Installaties BV, Alkmaar*  
TECU® Patina



**Yefei's Creative Street, Shanghai, VRC**  
Alsop, London, GB;  
U/Jiang Architects & Engineers, Shanghai  
*Hanchang Industrial Development Co., Shanghai*  
TECU® Patina, TECU® Oxid, TECU® Bronze

# TECU® References

## TECU® Oxid



**Production and office building, Baar, CH**  
Burkart, City of Baar Building Department Baar;  
Barkow Leibinger Architekten, Berlin  
*Gebr. Baur AG, Baar*  
TECU® Oxid

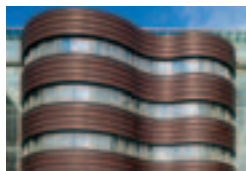

**Forum, Amsterdam, NL**  
Atelier PRO, The Hague  
*C.J. Ockeloen VOF, Amsterdam*  
TECU® Oxid



**Ferryman's House, Fænø Gods, Middelfart, DK**  
Schmidt, Hammer & Lassen A/S, Aarhus  
*Eddie Clement A/S, Ejby*  
TECU® Oxid



**Roche Forum, Buonas, CH**  
Scheitlin + Syfrig, Luzern  
*Gebr. Baur AG, Baar*  
TECU® Oxid

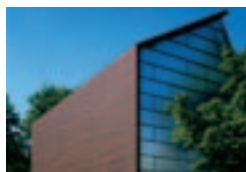

**University Stuttgart, Stuttgart, D**  
Rolf Loew, Stuttgart  
*Dangel GmbH, Lenningen*  
TECU® Oxid



**Motorway Toll Collection Area, Lucca, I**  
Architectural office Ettore Piras, Genoa  
*Trenkwalder S.r.l., Ovada*  
TECU® Oxid



**Production and office building of Elektro Graf, Dornbirn, A**  
Baumschlager & Eberle, Lochau  
*Güther GmbH, Feuchtwangen, D*  
TECU® Oxid



**Parque de la Relajación, Torrevieja, E**  
Toyo Ito & Associates, Tokyo, J;  
Toyo Ito Spain & Associates, Alicante, E  
*Vicente Escolano, Novelda, Alicante*  
TECU® Classic

## TECU® Zinn



**VCNON Traffic control centre, Wolfheze, NL**  
De Architecten Cie, Amsterdam  
*Verkoelen Dakbedekkingen BV, Beegden*  
TECU® Zinn



**Private residence, Herrliberg, CH**  
R. Baenziger, Zurich  
*Hersperger, Meilen (Façades);*  
*Studer AG, Volketswil (Plumbing)*  
TECU® Zinn



**St. Mary of the Angels, Rotterdam, NL**  
Mecanoo architecten, Delft  
*Leidekkersbedrijf Jobse BV, Middelburg*  
TECU® Zinn



**Administrative building of WeberHaus, Rheinau/Linx, D**  
Dipl.-Ing. Günter Hermann, Stuttgart  
*Wittenauer GmbH, Sasbach*  
TECU® Zinn



**Haus am Fluss (House by the river), DGF Stoess AG, Eberbach/Neckar, D**  
Dipl.-Ing. Günter Hermann, Stuttgart  
*Güther GmbH, Feuchtwangen*  
TECU® Zinn



**Japan Restaurant "My Sushi", Milano, I**  
Studio Clerici, Galizia e Totucci Associates,  
Arch. Lorenzo, Milano  
*Copermont S.r.l., Clusone (BG)*  
TECU® Zinn

**Object**  
Architects  
Copper Contractor  
Cladding



TECU® Brass  
TECU® Bronze  
TECU® Gold

TECU® Net  
TECU® Bond

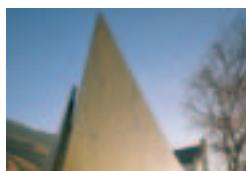

**Chiesa di San Giacomo, Laives (BZ), I**  
Höller & Klotzner Architetti, Merano (BZ)  
*Lavorazioni Metalli Renon SNC, Collalbo (BZ)*  
TECU® Brass

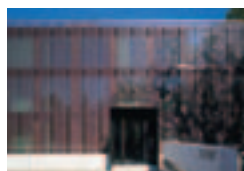

**Office building of the International Ice Hockey Federation, Zurich, CH**  
Tilla Theus und Partner AG, Zurich  
*Scherrer Söhne AG, Zurich*  
TECU® Net Classic



**UEC – Urban Entertainment Centre, Almere, NL**  
Will Alsop Architects, London  
*Ridder Dak- en Wandsystemen BV, Hoorn*  
TECU® Brass



**InnovationsCampus, Wolfsburg AG, Wolfsburg, D**  
O.M. Architekten BDA, Braunschweig  
*Bisping GmbH & Co., Münster*  
TECU® Net Patina



**Cimitero Trescore, I**  
Ing. Augusto Zambelli, Trescore Balneario (BG);  
Arch. Basilia Barcella, Bergamo  
*EFFEGI Costruzioni S.r.l., Castelli Calepio (BG)*  
TECU® Bronze



**BTV Bank, Innsbruck, A**  
Hanno Vogl-Fernheim, Innsbruck  
*Spengler & Glaserei Anker, Hall*  
TECU® Net Bronze



**Koningshof, Maassluis, NL**  
Hans Goverde, Kraaijvanger Urbis, Rotterdam  
*MSH Installatie- en Dakdekkersbedrijf BV, Schiedam*  
TECU® Gold



**Private Residence, Affoltern am Albis, CH**  
Deon AG, Luzern  
*W.O.B. GmbH, Wolfenschiessen*  
TECU® Net Classic



**Haus Metzner, Residential and Care Centre for the Aged, Cremlingen-Gardessen, D**  
Jörg Baumeister, m3xh, Braunschweig  
*Musche GmbH, Magdeburg*  
TECU® Gold



**Private Residence, Nuremberg, D**  
Haid+Partner Architekten+Ingenieure, Nuremberg  
*Schlosserei Spengler & Strassl, Arnstorf*  
TECU® Bond

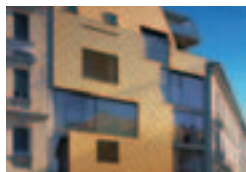

**Residential Building Grazbachgasse, Graz, A**  
INNOCAD Planung und Projektmanagement GmbH, Graz  
*Steinbauer, Judenburg*  
TECU® Gold

**KM Europa Metal AG**

*Project Consulting*  
Klosterstraße 29  
49074 OSNABRÜCK  
GERMANY  
Fon +49 541 321-2000  
Fax +49 541 321-2111  
info-tecu@kme.com  
www.kme.com

**Fricke GmbH & Co.KG**

Postfach 21 51  
48261 GREVEN  
GERMANY  
Fon +49 2575 309-0  
Fax +49 2575 309-25  
info-fricke-germany@kme.com  
www.fricke-greven.com

**Europa Metalli S.p.A.**

*Project Consulting*  
Via Corradino d'Ascanio, 4  
20142 MILANO  
ITALY  
Fon +39 02 89388-452  
Fon +39 02 89388-206  
Fax +39 02 89388-478  
info-tecu-italy@kme.com  
www.kme.com

Via della Repubblica, 259  
55052 FORNACI DI BARGA (LU)  
ITALY  
Fon +39 05 8370-1612  
Fax +39 05 8370-1404  
info-tecu-italy@kme.com  
www.kme.com

**Tréfinétaux S.A.**

*Project Consulting*  
11 bis, rue de l'Hôtel de Ville  
92411 COURBEVOIE CEDEX  
FRANCE  
Fon +33 1 47896-849  
Fax +33 1 47896-932  
info@trefimetaux.com  
www.trefimetaux.com

**KME America Inc.**

1000 Jorie Boulevard, Suite 111  
OAK BROOK, Illinois 60523  
USA  
Fon +1 630 990-2025  
Fax +1 630 990-0258  
sales@kmeamerica.com  
www.kme-america.com

**KME Asia Pte. Ltd.**

No. 7, Clementi Loop  
SINGAPORE 129811  
SINGAPORE  
Fon +65 6337-8671  
Fax +65 6337-8571  
info-asia@kme.com

**KME Austria**

**Vertriebsgesellschaft m.b.H.**  
Slamastraße 48  
Postfach 128  
1232 WIEN  
AUSTRIA  
Fon +43 1 6167986-0  
Fax +43 1 6167986-36  
info-at@kme.com  
www.kme-austria.com

**NV KME Benelux SA**

Leuvenbaan 3  
1820 STEENOKKERZEEL  
BELGIUM  
Fon +32 2 720-1889  
Fax +32 2 720-8780  
info-benelux@kme.com  
www.kme-benelux.com

*Netherlands:*

J.E. van Nieuwkoop  
P/a Postbus 146  
3300 AC DORDRECHT  
NETHERLANDS  
Fon +31 78 6212991  
Fax +31 78 6212048  
info-nl@kme.com

**KME Czech Republic s.r.o.**

nám. Sítná 31 05  
27201 KLADNO  
CZECH REPUBLIC  
Fon +42 312 608250  
Fax +42 312 608251  
info-cz@kme.com  
www.kme-czechrepublic.com

**KME Danmark A/S**

Landbrugsvej 8  
5260 ODENSE S  
DENMARK  
Fon +45 65 916410  
Fax +45 65 916411  
info-dk@kme.com  
www.kme-scandinavia.com

*Sweden:*

KME Danmark A/S, Sweden  
Box 118  
64723 MARIEFRED  
SWEDEN  
Fon +46 15 910612  
Fax +46 15 910613  
info-s@kme.com  
www.kme-scandinavia.com

**KME Hungaria Színesfém Kft.**

Andor u. 47 - 49  
VI. em. 616 - 618  
1119 BUDAPEST  
HUNGARY  
Fon +36 1 2059775  
Fax +36 1 2059776

**KME Ibérica S.L.**

Ctra Sabadell Mollet, km5  
Sta. Perpètua de Mogoda  
08130 BARCELONA  
SPAIN  
Fon +34 93 5747090  
Fax +34 93 5747091  
info-iberica@kme.com  
www.kme-iberica.com

**KME Polska SP. zo. o.**

Ul. Potocka 14  
01-652 WARSZAWA  
POLAND  
Fon +48 12 4116370  
Fax +48 12 4116370  
info-polska@kme.com  
www.kme-polska.com

**KME (Suisse) SA**

Moosstrasse 2  
Postfach  
8803 RÜSCHLIKON  
SWITZERLAND  
Fon +41 43 3882000  
Fax +41 43 3882001  
info-ch@kme.com  
www.kme-suisse.com

Case postale 111  
Av. de Châteleine 91a  
1219 CHÂTELEINE-GENÈVE  
SWITZERLAND  
Fon +41 22 9790660  
Fax +41 22 7966610  
info-ch@kme.com  
www.kme-suisse.com

**KME Yorkshire Ltd.**

Knightsbridge Park  
Wainwright Road  
WORCESTER  
WR4 9FA  
UNITED KINGDOM  
Fon +44 1905 751800  
Fax +44 1905 751801  
info-uk@kme.com  
www.kme-uk.com

® = registered trademark

All changes reserved.

Owing to limitations in printing technology, the colours reproduced in this brochure should be regarded as approximate equivalents to the colours described.

0107.030.0504