

# TECU® Classic

Copper for Roofing and  
Façade Cladding



KM Europa Metal AG  
TECU® Classic  
[GB]



Quality	2
The Surface	4
Processing and Installation	6
Copper and Sustainability	8

TECU® System Products	10
TECU® Sizes and Availability	14
TECU® Project Consulting	16
TECU® References	18





## *Lasting value, durable yet changeable*



*In the beginning, the architecture grade material is bright red rolled copper. But what follows is an ever-changing spectacle of weather, light and the natural, lively language of the material: After installation on the building, TECU® Classic retains its typical bright red copper colouring for a period of time. Changes are very gradual and not entirely predictable – just like the weather, which, in turn, is solely responsible for copper's continual changes. First, the surface turns matt. Gradually, the material develops an oxide layer to protect it against the effects of weathering. This process brings with it striking colour variations through an entire range of brown tones, offering varying nuances according to change of light and season.*

*Ultimately, on the sloping surfaces, the colour process yields a robust green patina – as is typical for copper surfaces. This patina lends the cladding its distinctive character, at the same time providing long-lasting protection for decades to come.*

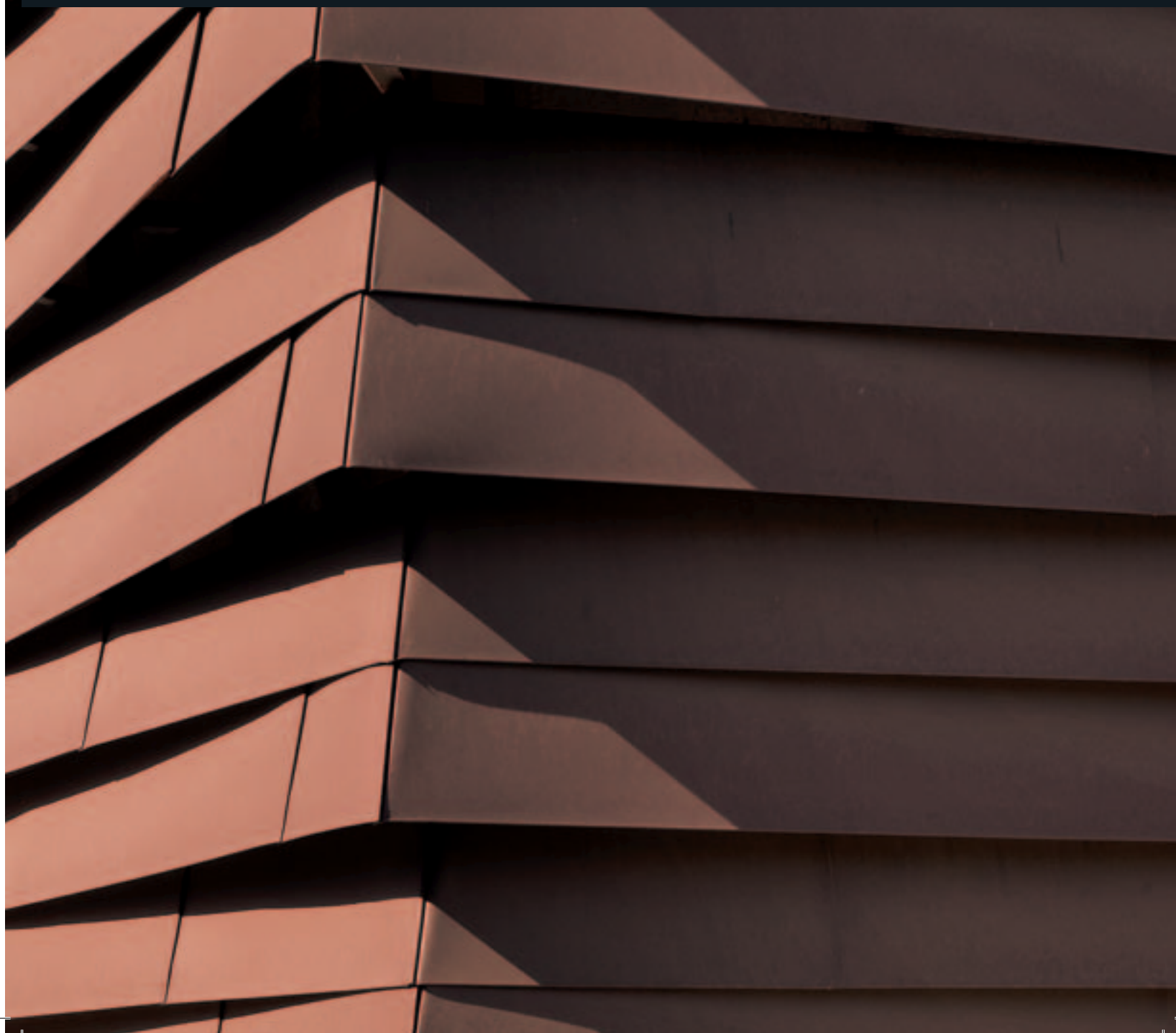



*“This material will always  
be among the most beautiful  
that architecture has to offer.”*

TECU® Classic sheets and strips are manufactured in state-of-the-art production facilities according to DIN EN 1172 and KME's own strict guidelines. They are made of Cu-DHP – oxygen-free, phosphorus-deoxidised copper with limited residual phosphorus. Cu-DHP is well suited to welding and soldering, and its purity levels according to DIN 1787 “Copper, Semi-Finished” amounts to at least 99.9%. Cu-DHP is outstandingly malleable, regardless of temperature or the direction of rolling.

Both roofing and façade grades surpass the requirements of DIN EN 1172 in relation to tolerances and the most important technological values. This gives the processed surface an excellent visual appearance.







*“The parts of the structure form a harmonious whole, and every detail brings across the designer’s original idea.”*

Initially, TECU® Classic sheets and strips have the optical quality of a blank copper surface. After installation, they develop a matt dark brown colouring from weathering and oxidation. On sloping surfaces, the oxide layers transform due to the influences of substances in the air and moisture when alkaline copper compounds are formed. A typical copper patina green develops over time. This lends the building an unmistakeable accent, and also gives rise to protective qualities that ensure an outstanding longevity of the material.





# TECU® Classic

## Processing and Installation



After installation, the physical appearance of TECU® Classic is influenced by the installation and the system applied. A combination of copper's typical properties, such as malleability, high ultimate elongation, high melting point etc. lend TECU® Classic its special suitability for all metal-specific processing techniques, from traditional seaming to modern cladding. Façade-grade and roofing-grade TECU® Classic are available for a very wide range of constructions. Both grades surpass the requirements laid out in DIN EN 1172 and make it possible to achieve excellent visual effects on wall cladding and roofing. The enhanced façade grade, with its greater flatness tolerance, is especially suited to exterior wall cladding.

*“What a material!  
What possibilities!”*

# Copper and sustainability

Copper is the building material for aesthetic, ambitious and long-term cost-effective building solutions. The advantages of copper in the installation process and the fact that it can be completely recycled make it an outstanding choice of material for roofing and façade cladding.

Recycling comprises the entire process of preparing old material and scraps for reuse in subsequent production processes. The recycling of copper is as old as the use of copper itself. Copper is primarily used for projects requiring a long lifespan. Taking average use and return times, copper achieves a recycling rate of around 80 % over all of its various areas of application. Energy savings gained from the use of recycled copper material – sometimes known as secondary metal production – amount to as much as 92 % (depending on the type of scrap being processed) of the energy input required for the ore extraction and subsequent production processes.

Today, ecological considerations in relation to the choice of construction materials have joined aesthetic and economic aspects, and are the subject of intense public interest. Recycling copper helps the environment both directly and indirectly. Use of reused materials prevents waste and protects natural resources.

Sustainable construction is aimed at minimising the consumption of energy and resources and contaminating the economy of nature as little as possible in every phase of a building's lifecycle. The model of sustainable development aims at linking ecological, economic and social goals with one another.

## *Taking copper as an example*

**Ecological** means handling energy and resources sparingly and affecting the eco system as little as possible.

**Economic** means that it provides cost-effective solutions. In view of its exceptional durability and the fact that it is virtually maintenance free, copper is the right choice for the entire lifecycle of the product.

**Social** means that the copper industry is a key economic industry that works together with other industries to lay the foundation for technological progress and contribute towards improving our standard of living.







# TECU® System Products

## TECU® for Seamed and Batten Cap Cladding

Ideal for custom designed free forms as well as the traditional roof and façade construction design: using angle standing seams and batten cap cladding. TECU® Classic for these types of cladding is available in sheets and strips.

The modern use of rolled copper in facade and roofing, the higher product quality requirements and the development of new, more demanding techniques for metalworking mean that copper has to meet much higher expectations today than ever before. TECU® sheets and strips for facade and roofing are manufactured in accordance with EN 1172 and KME's own strict quality control guidelines. Material tolerances for dimensions and properties are well within or even tighter than standard limits, and further processing by machine or hand is considerably easier.

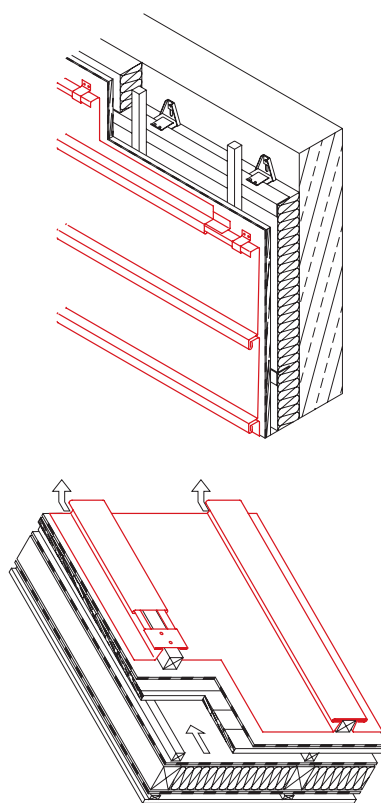

**TECU® System Shingles**  
**TECU® System Rhomboids**



Besides their special aesthetic qualities, TECU® System Shingles and TECU® System Rhomboids offer decisive economic advantages in façade design: cladding elements are laid simply by hanging them and interlocking them with each other.

The shingles and diamond system shingles have a 180° border on all sides. Two sides are provided with a fold coming forward or with a downstand. The individual elements are available as left or right tiling. All folds and notches are automatically pre-processed in the factory. At the edges, all the usual processing techniques such as bevelling, folding and bending can be used. This ensures that the corners of buildings and connections to other constructional elements such as windows and doors are completely weatherproof.

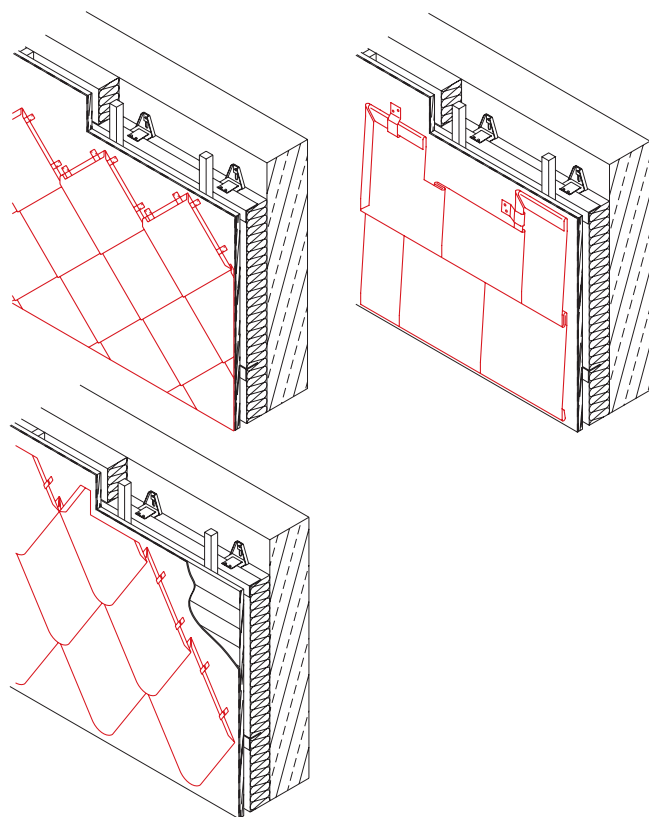

## TECU® Panels

TECU® Panels are two-sided cladding elements, with or without an end base, depending on the construction. Individual lengths are as long as 4,000 mm with a standard width of up to approx. 500 mm. Assembly at the building site is performed according to the tongue and groove principle or by overlapping.

The panels can be assembled in various directions – vertically, horizontally or diagonally. There are three basic forms, depending on the design:

- Slot-in panels laid vertically as a level surface facade cladding
- Slot-in panels laid horizontally as a level surface facade cladding
- Special panels with visible or concealed fixings, laid in various ways, with a level surface or overlapped

## TECU® Cassettes

TECU® Cassettes are cladding elements with folded edges on all sides available in a range of geometrical proportions from 1:1 to 1:4. They are exclusively pre-profiled to the customer's specifications and/or according to suggestions made by the architect.

Cassette cladding allows a great deal of flexibility concerning formats, the layout of joints and fixing principles. Folded edges on every side allow even larger sheet metal parts to lie even with the cladding surface.

Fixing is usually achieved by riveting, screwing, hidden/subsurface fittings or by means of bolt hooks to fix the cassettes directly to the substrate.

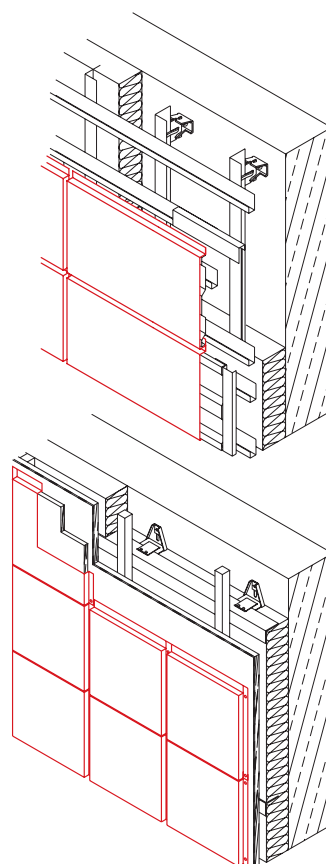
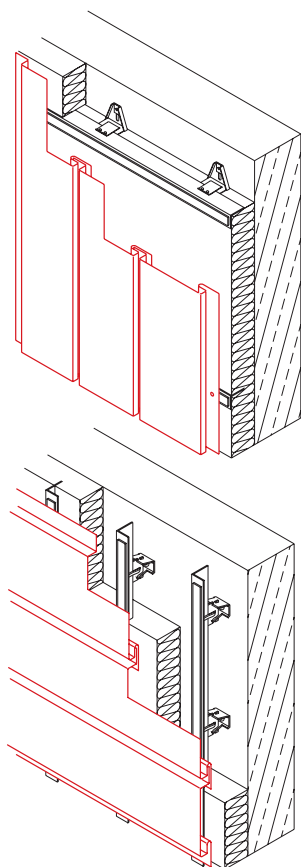



# TECU® Rainwater Systems

TECU® roofing and cladding systems can be supplemented by rainwater system components from Fricke GmbH & Co. of Greven, Germany.





Their product range includes

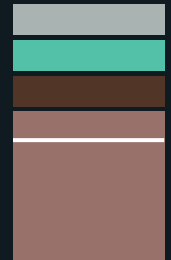





- eaves gutters, half-round (lengths of 3 – 6 m) or
- eaves gutters, box section (lengths of 2 or 3 m)
- gutter brackets
- downpipes
- rainwater pipe brackets
- standpipe
- accessories







# TECU® Sizes and Availability

## TECU® Sheets



TECU® Classic		0.5	0.6	0.7	1.0	1.2	1.5	2.0
Format/Thickness								
 1000 x 2000			•	•	•		•	•
 1000 x 3000			•	•	•		•	•
 1250 x 2500			•	•	•		•	•

TECU® Patina		0.5	0.6	0.7	1.0	1.2	1.5	2.0
Format/Thickness								
 600 x 2000				•				
 600 x 3000				•				
 670 x 2000			•	•				
 670 x 3000			•	•				
 800 x 3000				+	+			
 1000 x 2000			•	•	+	+		
 1000 x 3000			•	•	•	+	+	





Manually patinated longer sheets available on request

TECU® Brass		0.5	0.6	0.7	1.0	1.2	1.5	2.0
Format/Thickness								
 670 x 2000				•				
 670 x 3000				•				
 1000 x 2000				•	•			
 1000 x 3000				•	•			+

Burnishing by FRICKE GmbH & Co. KG available on request

TECU® Bronze		0.5	0.6	0.7	1.0	1.2	1.5	2.0
Format/Thickness								
 670 x 2000				•	•			
 670 x 3000				•	•			











Burnishing by FRICKE GmbH & Co. KG available on request



TECU® Gold		0.5	0.6	0.7	1.0	1.2	1.5	2.0
Format/Thickness								
 670 x 2000		+		•	•			
 670 x 3000		+		•	•			
 1000 x 2000				+	+			
 1000 x 3000				+	+			



- available
- + on request



Other dimensions and availability available on request.  
Further information: Project Consulting, Tel. +49 541 321-2000  
All measurements in mm.

## TECU® Strips

TECU® Classic		0.5	0.6	0.7	1.0
Width/Thickness					
 200			•	•	
 250			•	•	
 333			•	•	
 400			•	•	
 500			•	•	
 600			•	•	
 670			•	•	
 800			•	•	
 1000			•	•	
 1220			•	•	
 1250			•	•	

TECU® Oxid		0.5	0.6	0.7	1.0
Width/Thickness					
 500			•	•	
 600			•	•	
 670			•	•	

TECU® Zinn		0.5	0.6	0.7	1.0
Width/Thickness					
 500			+	+	
 600			•	•	
 670			•	•	

TECU® Brass		0.5	0.6	0.7	1.0
Width/Thickness					
 670				+	+
 1000				+	+

TECU® Bronze		0.5	0.6	0.7	1.0
Width/Thickness					
 670				+	+

TECU® Gold		0.5	0.6	0.7	1.0
Width/Thickness					
 1000		+		+	+

## TECU® Net TECU® Bond

## TECU® System Products

### TECU® Net (stretch levelled)

Thickness	0.7	1.0
Format 1000 x 2000	•	•
Format 1000 x 3000	•	•
TECU® Net Classic	•	•
Other formats available on request		

### TECU® Net (stretched)

Thickness	1.2
Format	on request
TECU® Net Classic	+
TECU® Net Patina	+

### TECU® Net (perforated)

Thickness	1.0
Format 1000 x 2000	
TECU® Net Classic	+
TECU® Net Patina	•
TECU® Net Brass	+
Thickness	1.0
Format max. 670 x 2000	
TECU® Net Bronze	+
TECU® Net Gold	+
Other formats available on request	

### TECU® Bond

Nominal thickness	4.0
Thickness of copper 0.3 on both surfaces (alternatively 0.5)	
Format 1000 x 3000	
TECU® Bond Classic	•
TECU® Bond Patina	+
TECU® Bond Brass	+
TECU® Bond Gold	+

### TECU® System Shingles

Format	600 x 600	600 x 600
	Rectangular	square
TECU® Classic	•	•
TECU® Oxid	•	•
TECU® Patina	•	•
TECU® Zinn	•	•
TECU® Brass	+	+
TECU® Bronze	+	+
TECU® Gold	+	+
Manufacture and sale: FRICKE GmbH & Co. KG		

### TECU® System Rhomboids

Format	518 x 830	518 x 758
	Sharp	Round
TECU® Classic	•	•
TECU® Oxid	•	•
TECU® Patina	•	•
TECU® Zinn	•	•
TECU® Brass	+	
TECU® Bronze	+	+
TECU® Gold	+	+
Manufacture and sale: FRICKE GmbH & Co. KG		

### TECU® Façade Tiles

Format	200 x 200
TECU® Classic	•
TECU® Gold	+
Manufacture and sale: FRICKE GmbH & Co. KG	

### TECU® Panels

Lengths up to 4000, Widths up to 400	
TECU® Classic	•
TECU® Oxid	•
TECU® Patina <sup>1</sup>	•
TECU® Zinn	•
TECU® Brass	•
TECU® Bronze	•
TECU® Gold	•
<sup>1</sup> Lengths up to 3000	
Manufacture and sale: FRICKE GmbH & Co. KG	

### TECU® Cassettes

Custom manufacturing	
TECU® Classic	•
TECU® Oxid	•
TECU® Patina	•
TECU® Zinn	•
TECU® Brass	•
TECU® Bronze	•
TECU® Gold	•
Manufacture and sale: FRICKE GmbH & Co. KG	

### TECU® Profiled sheets

Corrugated and trapezoidal profiles	
Formats available on request	
TECU® Classic	+
TECU® Oxid	+
TECU® Patina	+
TECU® Zinn	+
TECU® Brass	+
TECU® Bronze	+
TECU® Gold	+
Manufacture and sale: FRICKE GmbH & Co. KG	



# TECU® Project Consulting

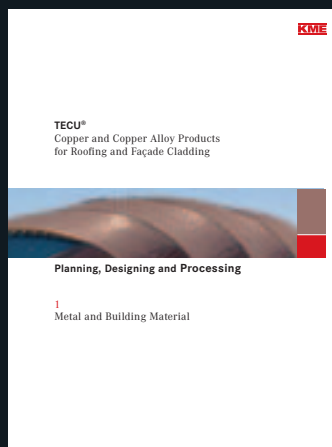

## Service

TECU® products from KME are made to meet the demands placed on them by all kinds of different constructions. Many of their recognized, quality features are a result of close communication with expert customers in the building industry.

TECU® stands for a combination of high quality and complete service. As the world's leading processor and refiner of copper and copper alloy products, KME provides its technical advisory service to developers, architects, clients and roofers throughout Europe and beyond.

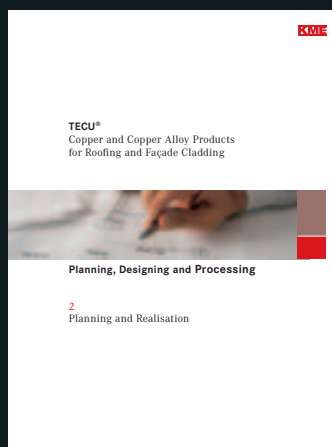

Information and consultation provided by TECU® Project Consulting ensure skilful use of materials, and make possible the realisation of perfect and aesthetically demanding solutions with TECU® products. The reference publication *TECU® - Planning, Designing and Processing*, is a rich source of detailed information – now available in five languages.



### Seminars and training courses

For everyday work in an architect's office, practical knowledge about the professional use of high-quality TECU® products is just as valuable as having reliable information about legal and organisational issues or new technologies. KME invites anyone with an interest in these issues to take part in special seminars for architects, which are held regularly in the **KMEForum** in Osnabrück.

The aesthetic and economic superiority of TECU® products is fully exploited when the material is used in a qualified manner in accordance with technical requirements. KME's TECU® Training Centre in Osnabrück offers multi-level professional seminars in which theoretical and practical processing techniques are taught at various levels of difficulty. Students apply their skills in practical work on models. The training events take place in the new **KMEForum** in Osnabrück, which is fully equipped with all modern training facilities, and offers a practice-oriented setting.



Courses are offered throughout Europe in collaboration with trade organisations and associations. This service is part of TECU® quality offered by KME.

# TECU®

## Copper designs.

### Reference

**The Eden Project in Cornwall, which surrounds its visitors with plant life in three different climate zones in colossal greenhouses, has now been expanded to include a learning and exhibition centre. The building's use of material and design strictly follow principles found in nature; the spectacular roof construction is completely clad with TECU® Classic.**

The largest greenhouses in the world have been amazing visitors with their impressive plant worlds since March 2001. Plants of different sizes are housed here in eight connected geodesic domes with radii of 18 to 65 metres. These are described as "biomes". Visitors big and small can now also learn about the diverse processes in nature in a new learning centre (The Core). The construction of the new building corresponds to the design of a plant, including a "stem" and a canopy roof to shade the ground and soak up the sun's energy. The overhanging curved roof is a central element of the architecture: a wood construction clad in copper, which stretches outwards from the centre of the building in a spiral, to finally touch the ground at three points. The roof design is based on the so-called Fibonacci Spirals, a mathematically developed pattern derived from the analysis of naturally occurring shapes in sunflowers, pinecones and sprouting plants. Thus, the building portrays a sense of beauty and proportion in its design which meets the commitment of the Eden Project to foster our appreciation of the exciting world of plants. Because of its ideal malleability, TECU® Classic provided the architects with an ideal solution for the special demands placed on the roof cladding in this project. The longevity and resilience of copper, along with its unlimited recycling capability, were equally decisive factors in choosing the material, particularly as the project required that only durable, natural and environmentally-friendly, sustainable materials be used. A further requirement to be met in the construction of the Information Centre was that there be complete transparency in relation to the origin, transport routes taken and processing of all materials used in the project. That is why the Eden Project team actually checked for itself the sustainability of TECU® materials, which are produced by KME at five European locations.

#### **THE CORE, Information Centre for the Eden Project, Cornwall, GB**

Architects: Nicholas Grimshaw & Partners, London

Copper Contractor: Richardson Roofing Co. Ltd., Staines

**Cladding: TECU® Classic**





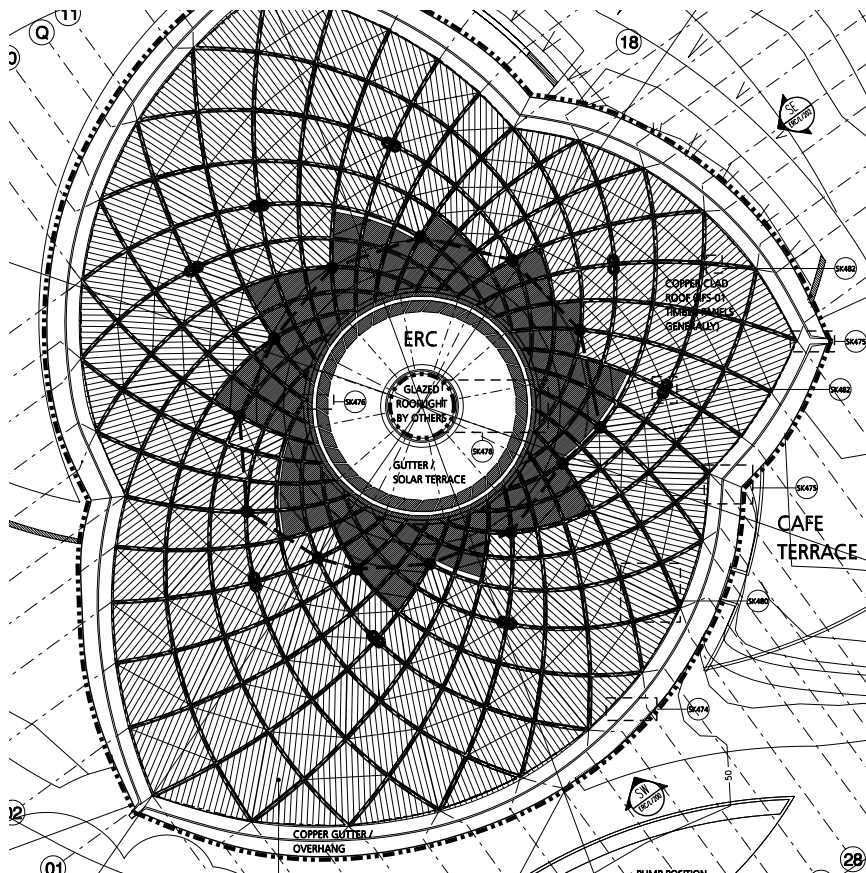

# TECU®

## Copper designs.

### Reference

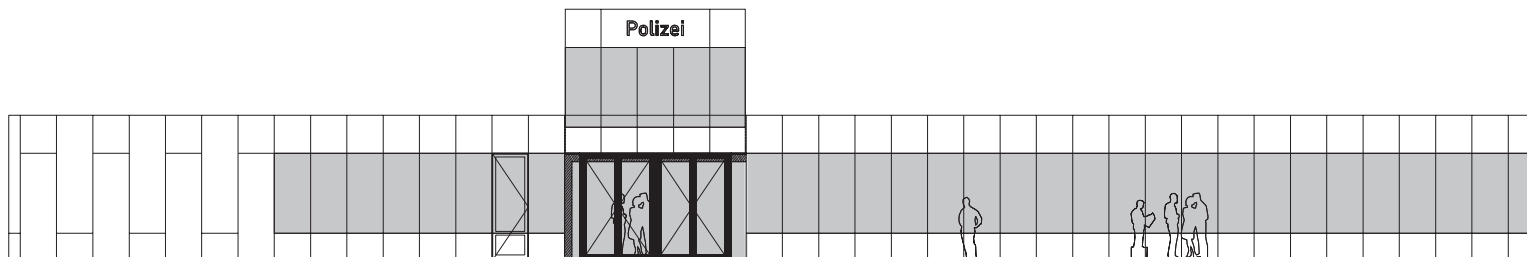

**Service centre on the Theresienwiese, Munich, D**  
 Architects: Volker Staab Architekten, Berlin  
 Copper Contractor: Regensburger Metallbau, Regensburg  
 Cladding: TECU® Classic

**The new service centre on the Theresienwiese in Munich looks on first sight like a kind of copper bar lying on a large, flat field. The facade and roof of the monolith-like building are almost completely clad in bright copper. This perfect design in form and craftsmanship was awarded the first prize in the TECU® Architecture Award 2005.**

The world's largest public festival is set up on Munich's Theresienwiese every year in late summer. With around 6 million visitors, the festival faces tough challenges in terms of organisation and looking after its visitors. The new Service Centre is a perfect building for housing public authorities, police and medical services during the festival season.

The internal structure of the "copper" body is only revealed by the changes in its surface material between plain and perforated TECU® Classic sheets. The rooms used by the public are glazed and the copper sheeting protects them from both excessive solar radiation and vandalism. As the entire building is clad, all areas accessible from outside are protected. The external appearance of the building changes every year when it is opened up at the beginning of the festival: three large vertical lift roller shutters, partly covered with perforated TECU® copper, identify from a long distance away the three public entrances in the east wing of the building. Illuminated signs mark the entrances "Festival Management", "First Aid", "Police".

The building presents itself in a precise and simple form and with its structure adapted exclusively to the complex demands of functionality. It nestles inconspicuously on the grassland and is intended, with the living material of its copper shell, like a chameleon, to gradually blend into the colour palette of the Theresienwiese. Over time, the oxidation of the copper cladding on the building will cause it to take on the hues of the sloping ridge behind it. It will take about a year for the TECU® Classic cladding to turn a dark brown to black colour. In time the green patina, which is typical of copper, will begin to form on the roof and facade areas directly exposed to weathering, meaning that the structure will then finally be visually in tune with the environment in which it is located.





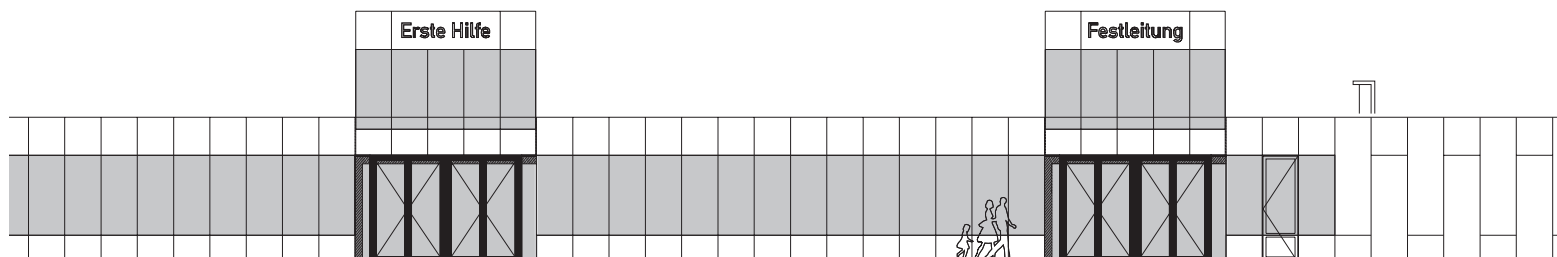

# TECU® References

TECU® Classic

TECU® Classic



**De Young Memorial Museum, San Francisco, USA**  
Herzog & de Meuron Architekten, Basel, CH  
*A. Zahner Co. Architectural Metals, Kansas City*  
TECU® Classic



**Service Centre Theresienwiese, Munich, D**  
Volker Staab Architekten, Berlin  
*Regensburger Metallbau, Regensburg*  
TECU® Classic



**Poppodium Mezz, Breda, NL**  
(EEA) Erick van Egeraat associated architects, Rotterdam  
*SV Metaaldak Specialist BV, Beek en Donk / Brouwers Zink BV, Maasmechelen*  
TECU® Classic



**Offices and industrial building, Koblach, A**  
AIX Architects, Feldkirch  
*Peter GesMBH + CoKG, Koblach*  
TECU® Classic

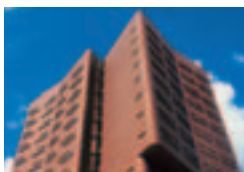

**Officer's quarters of the Royal Marines of the Netherlands, Den Helder**  
Van Herk & de Kleijn Architekten BV, Amsterdam  
*Ridder BV, Hoorn*  
TECU® Classic



**Casa Travella, Castel San Pietro, CH**  
Aldo Celoria, Balerna  
*Antonio Corti SA, Caslano*  
TECU® Classic



**Harbour Control Tower, Lisbon, P**  
Gonçalo Byrne, G.B. Arquitectos, Lisbon  
*Zn-Revestimentos de Zinco Lda., Maia*  
TECU® Classic

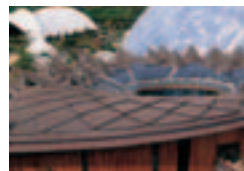

**THE CORE, Information Centre for the Eden Project, Cornwall, GB**  
Nicholas Grimshaw & Partners, London  
*Richardson Roofing Co. Ltd., Staines*  
TECU® Classic



**ESA - École Supérieure d'Art, Clermont-Ferrand, F**  
Architecture Studio, Paris  
*Raimond SA, Saint-Julien de Condelles*  
TECU® Classic



**Private Residence, Madrid, E**  
Bernalte y León Asociados, Ciudad Real  
*METAZINCO®, Madrid/Olloniego (Asturias)*  
TECU® Classic



**Kulturhus De Bijenkorf, Borne, NL**  
MAS architectuur BV, Hengelo  
*Dakcentrum+, Beilen*  
TECU® Classic

**Object**  
Architects  
Copper Contractor  
Cladding



TECU® Patina

TECU® Patina



**Galway-Mayo Institute of Technology, Galway, IRL**  
Murray O'Laoire Architects, Cork  
*Let it Rain Roofing Ltd., Galway*  
TECU® Patina



**Villa ArenA (Restaurant), Amsterdam, NL**  
Virgile & Stone Associates Ltd., London  
in cooperation with Benthem Crouwel Architecten  
*Leebo bouwsystemen BV, Drunen*  
TECU® Patina



**Maggie's Highlands Cancer Caring Centre at Raigmore Hospital, Inverness, GB**  
Page & Park Architects, Glasgow  
*W B Watson Ltd., Stewarton*  
TECU® Patina, TECU® Oxid



**Peckham Library, London, GB**  
Alsop & Störmer, London  
*Clevecio, Enfield*  
TECU® Patina



**Pilgrimage Church Padre Pio, San Giovanni Rotondo, I**  
Renzo Piano Building Workshop, Genoa  
*WAL S.R.L., Bregnano*  
TECU® Patina



**Centro Stampa Quotidiani, Brescia, I**  
TECNE s.r.l., Brescia  
*Santinato, Erbusco*  
TECU® Patina



**Entrance to University Library, Debrecen, H**  
János Golda, János Megyik, Gábor Szenderffy, Budapest  
*Szolnok KAS Kft, Szolnok*  
TECU® Patina



**Office and shop building "KAI 13", Düsseldorf, D**  
Döring Dahmen Joeressen Architekten, Düsseldorf  
*Zitzen GmbH, Mönchengladbach*  
TECU® Patina



**"Thunderbird" House, Poole, GB**  
Seven Developments Ltd., Poole  
*Pace Roofing Ltd., Romsey*  
TECU® Patina

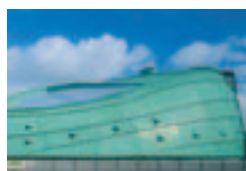

**ICL - International Centre for Life, Newcastle, GB**  
Terry Farell & Partners, London  
*Varla UK Ltd., Chester*  
TECU® Patina



**Underground station Hounslow West, London, GB**  
Michael Watkins (Partner), London, (Acanthus, Lawrence and Wrightson Architects)  
*Broderick Structures Ltd., Woking*  
TECU® Patina



**Urbis, Manchester, GB**  
Ian Simpson Architects, Manchester  
*Varla UK Ltd., Chester*  
TECU® Patina



**Private Residence, NL**  
Charles Slot Bureau Ruimtelijke Vormgeving, Bergen  
*PBK Technische Installaties BV, Alkmaar*  
TECU® Patina



**Yefei's Creative Street, Shanghai, VRC**  
Alsop, London, GB;  
U/Jiang Architects & Engineers, Shanghai  
*Hanchang Industrial Development Co., Shanghai*  
TECU® Patina, TECU® Oxid, TECU® Bronze

# TECU® References

## TECU® Oxid



**Production and office building, Baar, CH**  
Burkart, City of Baar Building Department Baar;  
Barkow Leibinger Architekten, Berlin  
*Gebr. Baur AG, Baar*  
TECU® Oxid

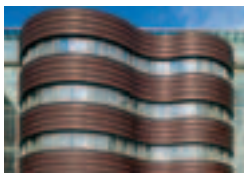

**Forum, Amsterdam, NL**  
Atelier PRO, The Hague  
*C.J. Ockeloen VOF, Amsterdam*  
TECU® Oxid



**Ferryman's House, Fænø Gods, Middelfart, DK**  
Schmidt, Hammer & Lassen A/S, Aarhus  
*Eddie Clement A/S, Ejby*  
TECU® Oxid



**Roche Forum, Buonas, CH**  
Scheitlin + Syfrig, Luzern  
*Gebr. Baur AG, Baar*  
TECU® Oxid



**University Stuttgart, Stuttgart, D**  
Rolf Loew, Stuttgart  
*Dangel GmbH, Lenningen*  
TECU® Oxid



**Motorway Toll Collection Area, Lucca, I**  
Architectural office Ettore Piras, Genoa  
*Trenkwalder S.r.l., Ovada*  
TECU® Oxid



**Production and office building of Elektro Graf, Dornbirn, A**  
Baumschlager & Eberle, Lochau  
*Güther GmbH, Feuchtwangen, D*  
TECU® Oxid



**Parque de la Relajación, Torrevieja, E**  
Toyo Ito & Associates, Tokyo, J;  
Toyo Ito Spain & Associates, Alicante, E  
*Vicente Escolano, Novelda, Alicante*  
TECU® Classic

## TECU® Zinn



**VCNON Traffic control centre, Wolfheze, NL**  
De Architecten Cie, Amsterdam  
*Verkoelen Dakbedekkingen BV, Beegden*  
TECU® Zinn



**Private residence, Herrliberg, CH**  
R. Baenziger, Zurich  
*Hersperger, Meilen (Façades);*  
*Studer AG, Volketswil (Plumbing)*  
TECU® Zinn



**St. Mary of the Angels, Rotterdam, NL**  
Mecanoo architecten, Delft  
*Leidekkersbedrijf Jobse BV, Middelburg*  
TECU® Zinn



**Administrative building of WeberHaus, Rheinau/Linx, D**  
Dipl.-Ing. Günter Hermann, Stuttgart  
*Wittenauer GmbH, Sasbach*  
TECU® Zinn



**Haus am Fluss (House by the river), DGF Stoess AG, Eberbach/Neckar, D**  
Dipl.-Ing. Günter Hermann, Stuttgart  
*Güther GmbH, Feuchtwangen*  
TECU® Zinn



**Japan Restaurant "My Sushi", Milano, I**  
Studio Clerici, Galizia e Totucci Associates,  
Arch. Lorenzo, Milano  
*Copermont S.r.l., Clusone (BG)*  
TECU® Zinn

**Object**  
Architects  
Copper Contractor  
Cladding

TECU® Brass  
TECU® Bronze  
TECU® Gold

TECU® Net  
TECU® Bond

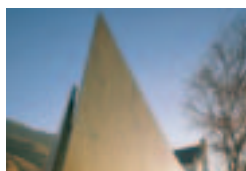

**Chiesa di San Giacomo, Laives (BZ), I**  
Höller & Klotzner Architetti, Merano (BZ)  
*Lavorazioni Metalli Renon SNC, Collalbo (BZ)*  
TECU® Brass

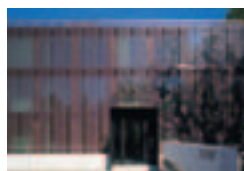

**Office building of the International Ice Hockey Federation, Zurich, CH**  
Tilla Theus und Partner AG, Zurich  
*Scherrer Söhne AG, Zurich*  
TECU® Net Classic



**UEC – Urban Entertainment Centre, Almere, NL**  
Will Alsop Architects, London  
*Ridder Dak- en Wandsystemen BV, Hoorn*  
TECU® Brass



**InnovationsCampus, Wolfsburg AG, Wolfsburg, D**  
O.M. Architekten BDA, Braunschweig  
*Bisping GmbH & Co., Münster*  
TECU® Net Patina



**Cimitero Trescore, I**  
Ing. Augusto Zambelli, Trescore Balneario (BG);  
Arch. Basilia Barcella, Bergamo  
*EFFEGI Costruzioni S.r.l., Castelli Calepio (BG)*  
TECU® Bronze



**BTV Bank, Innsbruck, A**  
Hanno Vogl-Fernheim, Innsbruck  
*Spengler & Glaserei Anker, Hall*  
TECU® Net Bronze



**Koningshof, Maassluis, NL**  
Hans Goverde, Kraaijvanger Urbis, Rotterdam  
*MSH Installatie- en Dakdekkersbedrijf BV, Schiedam*  
TECU® Gold



**Private Residence, Affoltern am Albis, CH**  
Deon AG, Luzern  
*W.O.B. GmbH, Wolfenschiessen*  
TECU® Net Classic



**Haus Metzner, Residential and Care Centre for the Aged, Cremlingen-Gardessen, D**  
Jörg Baumeister, m3xh, Braunschweig  
*Musche GmbH, Magdeburg*  
TECU® Gold



**Private Residence, Nuremberg, D**  
Haid+Partner Architekten+Ingenieure, Nuremberg  
*Schlosserei Spengler & Strassl, Arnstorf*  
TECU® Bond



**Residential Building Grazbachgasse, Graz, A**  
INNOCAD Planung und Projektmanagement GmbH, Graz  
*Steinbauer, Judenburg*  
TECU® Gold

**KM Europa Metal AG**

*Project Consulting*  
Klosterstraße 29  
49074 OSNABRÜCK  
GERMANY  
Fon +49 541 321-2000  
Fax +49 541 321-2111  
info-tecu@kme.com  
www.kme.com

**Fricke GmbH & Co.KG**

Postfach 21 51  
48261 GREVEN  
GERMANY  
Fon +49 2575 309-0  
Fax +49 2575 309-25  
info-fricke-germany@kme.com  
www.fricke-greven.com

**Europa Metalli S.p.A.**

*Project Consulting*  
Via Corradino d'Ascanio, 4  
20142 MILANO  
ITALY  
Fon +39 02 89388-452  
Fon +39 02 89388-206  
Fax +39 02 89388-478  
info-tecu-italy@kme.com  
www.kme.com

Via della Repubblica, 259  
55052 FORNACI DI BARGA (LU)  
ITALY  
Fon +39 05 8370-1612  
Fax +39 05 8370-1404  
info-tecu-italy@kme.com  
www.kme.com

**Tréfimétaux S.A.**

*Project Consulting*  
11 bis, rue de l'Hôtel de Ville  
92411 COURBEVOIE CEDEX  
FRANCE  
Fon +33 1 47896-849  
Fax +33 1 47896-932  
info@trefimetaux.com  
www.trefimetaux.com

**KME America Inc.**

1000 Jorie Boulevard, Suite 111  
OAK BROOK, Illinois 60523  
USA  
Fon +1 630 990-2025  
Fax +1 630 990-0258  
sales@kmeamerica.com  
www.kme-america.com

**KME Asia Pte. Ltd.**

No. 7, Clementi Loop  
SINGAPORE 129811  
SINGAPORE  
Fon +65 6337-8671  
Fax +65 6337-8571  
info-asia@kme.com

**KME Austria**

**Vertriebsgesellschaft m.b.H.**  
Slamastraße 48  
Postfach 128  
1232 WIEN  
AUSTRIA  
Fon +43 1 6167986-0  
Fax +43 1 6167986-36  
info-at@kme.com  
www.kme-austria.com

**NV KME Benelux SA**

Leuvenbaan 3  
1820 STEENOKKERZEEL  
BELGIUM  
Fon +32 2 720-1889  
Fax +32 2 720-8780  
info-benelux@kme.com  
www.kme-benelux.com

*Netherlands:*

J.E. van Nieuwkoop  
P/a Postbus 146  
3300 AC DORDRECHT  
NETHERLANDS  
Fon +31 78 6212991  
Fax +31 78 6212048  
info-nl@kme.com

**KME Czech Republic s.r.o.**

nám. Sítná 31 05  
27201 KLADNO  
CZECH REPUBLIC  
Fon +42 312 608250  
Fax +42 312 608251  
info-cz@kme.com  
www.kme-czechrepublic.com

**KME Danmark A/S**

Landbrugsvej 8  
5260 ODENSE S  
DENMARK  
Fon +45 65 916410  
Fax +45 65 916411  
info-dk@kme.com  
www.kme-scandinavia.com

*Sweden:*

KME Danmark A/S, Sweden  
Box 118  
64723 MARIEFRED  
SWEDEN  
Fon +46 15 910612  
Fax +46 15 910613  
info-s@kme.com  
www.kme-scandinavia.com

**KME Hungaria Színesfém Kft.**

Andor u. 47-49  
VI. em. 616-618  
1119 BUDAPEST  
HUNGARY  
Fon +36 1 2059775  
Fax +36 1 2059776

**KME Ibérica S.L.**

Ctra Sabadell Mollet, km5  
Sta. Perpètua de Mogoda  
08130 BARCELONA  
SPAIN  
Fon +34 93 5747090  
Fax +34 93 5747091  
info-iberica@kme.com  
www.kme-iberica.com

**KME Polska SP. zo. o.**

Ul. Potocka 14  
01-652 WARSZAWA  
POLAND  
Fon +48 12 4116370  
Fax +48 12 4116370  
info-polska@kme.com  
www.kme-polska.com

**KME (Suisse) SA**

Moosstrasse 2  
Postfach  
8803 RÜSCHLIKON  
SWITZERLAND  
Fon +41 43 3882000  
Fax +41 43 3882001  
info-ch@kme.com  
www.kme-suisse.com

Case postale 111  
Av. de Châteleine 91a  
1219 CHÂTELEINE-GENÈVE  
SWITZERLAND  
Fon +41 22 9790660  
Fax +41 22 7966610  
info-ch@kme.com  
www.kme-suisse.com

**KME Yorkshire Ltd.**

Knightsbridge Park  
Wainwright Road  
WORCESTER  
WR4 9FA  
UNITED KINGDOM  
Fon +44 1905 751800  
Fax +44 1905 751801  
info-uk@kme.com  
www.kme-uk.com

® = registered trademark

All changes reserved.

Owing to limitations in printing technology, the colours reproduced in this brochure should be regarded as approximate equivalents to the colours described.

0107.030.0504